

# 2025-2026 PRODUCT RANGE

## Animal Comfort Experts

[www.terrui.com](http://www.terrui.com)



**TERRUI**





## *Who we are:*

### *TERRUI INTERNATIONAL CO.,LTD.*

Terrui International Co., Ltd. was established in 2002 and specializes in the development, manufacturing, and sales of livestock equipment. Over the years, we have emerged as a leading global supplier of circulation fans, soaking systems, drinking waterers, calf hutches and pens, veterinary accessories, and electric fencing.

Since our inception, we have developed 200+ innovative products and secured 30+ patents. Committed to high product quality, we implemented a comprehensive quality management system, and our operations have been ISO 9001:2008 certified since 2013.

Our products are highly regarded worldwide, and we have successfully marketed them in over 120+ countries. Our mission is to enhance the health and comfort of livestock, contributing to better agricultural practices globally.





<b>1</b>	<b><i>Cooling and Soaking System</i></b>	<b>1-6</b>
	Cooling and Soaking System	1-6
<b>2</b>	<b><i>Livestock Fan</i></b>	<b>7-15</b>
	Circulation and Exhaust/Intake Fan	7-14
	Ceiling Fan	15-15
<b>3</b>	<b><i>Livestock Waterer</i></b>	<b>16-32</b>
	Water Trough	14-29
	Water Bowl	30-32
<b>4</b>	<b><i>Livestock House</i></b>	<b>33-36</b>
	Calf Hutch	33-35
	Calf Pen	36-36
<b>5</b>	<b><i>Veterinary Equipment</i></b>	<b>37-44</b>
	Veterinary Accessories	37-44
<b>6</b>	<b><i>Electric Fencing</i></b>	<b>42-97</b>
	Insulators	45-65
	Gate Handle	66-72
	Wire and Tape	73-78
	Strainer	79-81
	Post	82-88
	Toolings	89-97

# Livestock Fans-Panel Fans

## 38" PANEL FAN -EC MOTOR

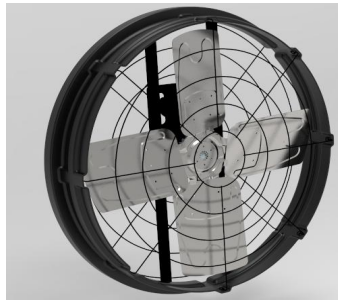

**APP**

**Control**

- ◎EC MOTOR, bring sgood heat emission,high efficiency(direct drive),big torque,long-life usage
- ◎Balanced4 stainless steel blades
- ◎Housing is made from heavy-duty, impact resistant polyethylene.One shot Roto-molded process brings the housing more strength and long-life usage, no rust forever
- ◎Large air volume,less noise gives more comfort to animals
- ◎With VFD,can be contoller by APP, PC automatically as the temp and humidity
- ◎Voltage,housing color can be customized
- ◎APP control, need to purchase gateway(DZJ902) and temperature sensor(DGY601485)

Part No#	Blade Dia cm	RPM	Air Flow m <sup>3</sup> /h	Power w	Phase	Drive Mode	Voltage	Frequency
YBA038DECGS 5380WMB0	96	750	27000	300	3	direct	380-480	50/60HZ

## 48" PANEL FAN -EC MOTOR



**APP**

**Control**

- ◎EC MOTOR, bring sgood heat emission,high efficiency(direct drive),big torque,long-life usage
- ◎Balanced 6 Aluminum blades
- ◎Housing is made from heavy-duty, impact resistant polyethylene.One shot Roto-molded process brings the housing more strength and long-life usage, no rust forever
- ◎Large air volume,less noise gives more comfort to animals
- ◎With VFD,can be contoller by APP, PC automatically as the temp and humidity
- ◎Voltage can be customized
- ◎APP control, need to purchase gateway(DZJ902) and temperature sensor(DGY601485)

Part No#	Blade Dia cm	RPM	Air Flow m <sup>3</sup> /h	Power w	Phase	Drive Mode	Voltage	Frequency
YBA048DECGS 6460WMA0	120	460	45000	850	3	direct	380-480	50/60HZ

# Livestock Fans-Panel Fans

## 55" PANEL FAN -EC MOTOR



**APP**

**Control**

- ◎EC MOTOR, bring sgood heat emission,high efficiency(direct drive),big torque,long-life usage
- ◎Balanced 6 Aluminum blades
- ◎Housing is made from heavy-duty, impact resistant polyethylene.One shot Roto-molded process brings the housing more strength and long-life usage, no rust forever
- ◎Large air volume,less noise gives more comfort to animals
- ◎With VFD,can be contoller by APP, PC automatically as the temp and humidity
- ◎Voltage can be customized
- ◎APP control, need to purchase gateway(DZJ902) and temperature sensor(DGY601485)

Part No#	Blade Dia cm	RPM	Air Flow m <sup>3</sup> /h	Power w	Phase	Drive Mode	Voltage	Frequency
YBA055DECGS 5380WMB0	140	460	66000	1200	3	direct	380-480	50/60HZ

## 63" PANEL FAN -EC MOTOR



**APP**

**Control**

- ◎EC MOTOR, bring sgood heat emission,high efficiency(direct drive),big torque,long-life usage
- ◎Balanced 6 Aluminum blades
- ◎Housing is made from heavy-duty, impact resistant polyethylene.One shot Roto-molded process brings the housing more strength and long-life usage, no rust forever
- ◎Large air volume,less noise gives more comfort to animals
- ◎With VFD,can be contoller by APP, PC automatically as the temp and humidity
- ◎Voltage can be customized
- ◎APP control, need to purchase gateway(DZJ902) and temperature sensor(DGY601485)

Part No#	Blade Dia cm	RPM	Air Flow m <sup>3</sup> /h	Power w	Phase	Drive Mode	Voltage	Frequency
YBA063DECGS VH6460WMA0	160	444	90000	1700	3	direct	380-480	50/60HZ

# Livestock Fans-Panel Fans

## 72" PANEL FAN -EC MOTOR



**APP**

**Control**

- ◎EC MOTOR, bring sgood heat emission,high efficiency(direct drive),big torque,long-life usage
- ◎Balanced 6 Aluminum blades
- ◎Housing is made from heavy-duty, impact resistant polyethylene.One shot Roto-molded process brings the housing more strength and long-life usage, no rust forever
- ◎Large air volume,less noise gives more comfort to animals
- ◎With VFD,can be contoller by APP, PC automatically as the temp and humidity
- ◎Voltage,housing color can be customized
- ◎APP control, need to purchase gateway(DZJ902) and temperature sensor(DGY601485)

Part No#	Blade Dia cm	RPM	Air Flow m <sup>3</sup> /h	Power w	Phase	Drive Mode	Voltage	Frequency
YBA072DECGS 5380WMB6	183	345	120000	2000	3	direct	380-480	50/60HZ

## 86" PANEL FAN -EC MOTOR



**APP**

**Control**

- ◎EC MOTOR, bring sgood heat emission,high efficiency(direct drive),big torque,long-life usage
- ◎Balanced 6 Aluminum blades
- ◎Housing is made from heavy-duty, impact resistant fiberglass, long-life usage, no rust forever
- ◎Large air volume,less noise gives more comfort to animals
- ◎With VFD,can be contoller by APP, PC automatically as the temp and humidity
- ◎Voltage can be customized
- ◎APP control, need to purchase gateway(DZJ902) and temperature sensor(DGY601485)

Part No#	Blade Dia cm	RPM	Air Flow m <sup>3</sup> /h	Power w	Phase	Drive Mode	Voltage	Frequency
YBA086DECGF WMA0	218	320	155000	3300	3	direct	380-480	50/60HZ



# Livestock Fans-Panel Fans

## 98" PANEL FAN -EC MOTOR



**APP**

**Control**

- ◎EC MOTOR, bring sgood heat emission,high efficiency(direct drive),big torque,long-life usage
- ◎Balanced 6 Aluminum blades
- ◎Housing is made from heavy-duty, impact resistant fiberglass, long-life usage, no rust forever
- ◎Large air volume,less noise gives more comfort to animals
- ◎With VFD,can be contoller by APP, PC automatically as the temp and humidity
- ◎Voltage,housing color can be customized
- ◎APP control, need to purchase gateway(DZJ902) and temperature sensor(DGY601485)

Part No#	Blade Dia cm	RPM	Air Flow m³/h	Power w	Phase	Drive Mode	Voltage	Frequency
YBA098DECGF 5380WMA0	248	300	228000	5000	3	direct	380-480	50/60HZ

## 114" PANEL FAN -EC MOTOR



**APP**

**Control**

- ◎EC MOTOR, bring sgood heat emission,high efficiency(direct drive),big torque,long-life usage
- ◎Balanced 6 Aluminum blades
- ◎Housing is made from heavy-duty, impact resistant fiberglass, long-life usage, no rust forever
- ◎Large air volume,less noise gives more comfort to animals
- ◎With VFD,can be contoller by APP, PC automatically as the temp and humidity
- ◎Voltage can be customized
- ◎APP control, need to purchase gateway(DZJ902) and temperature sensor(DGY601485)

Part No#	Blade Dia cm	RPM	Air Flow m³/h	Power w	Phase	Drive Mode	Voltage	Frequency
YBA114DECGF 5380WMA0	289	300	300000	8000	3	direct	380-480	50/60HZ

# Livestock Fans-Panel Fans

## SQUARE 38" PANEL FAN -EC MOTOR



APP

Control

- ◎EC MOTOR, bring sgood heat emission,high efficiency(direct drive),big torque,long-life usage
- ◎Balanced4 stainless steel blades
- ◎Housing is made from heavy-duty, impact resistant polyethylene.One shot Roto-molded process brings the housing more strength and long-life usage, no rust forever
- ◎Large air volume,less noise gives more comfort to animals
- ◎With VFD,can be contoller by APP, PC automatically as the temp and humidity
- ◎Voltage,housing color can be customized
- ◎APP control, need to purchase gateway(DZJ902) and temperature sensor(DGY601485)

Part No#	Blade Dia cm	RPM	Air Flow m <sup>3</sup> /h	Power w	Phase	Drive Mode	Voltage	Frequency
YBA10214IP5 5ECWMB0	96	750	27000	410	3	direct	380-480	50/60HZ

## SQUARE 45" PANEL FAN -EC MOTOR

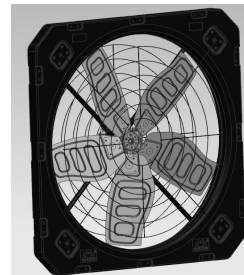

APP

Control

- ◎EC MOTOR, bring sgood heat emission,high efficiency(direct drive),big torque,long-life usage
- ◎Balanced5 stainless steel blades
- ◎Housing is made from heavy-duty, impact resistant polyethylene.One shot Roto-molded process brings the housing more strength and long-life usage, no rust forever
- ◎Large air volume,less noise gives more comfort to animals
- ◎With VFD,can be contoller by APP, PC automatically as the temp and humidity
- ◎Voltage can be customized
- ◎APP control, need to purchase gateway(DZJ902) and temperature sensor(DGY601485)

Part No#	Blade Dia cm	RPM	Air Flow m <sup>3</sup> /h	Power w	Phase	Drive Mode	Voltage	Frequency
YBA11214IP5 5ECWMB0	115	610	40700	610	3	direct	380-480	50/60HZ



# Livestock Fans-Fans

## 72" LOUVERED FAN -EC MOTOR



**APP**

**Control**

- ◎EC MOTOR, bring sgood heat emission,high efficiency(direct drive),big torque,long-life usage
- ◎Balanced 6 Aluminum blades
- ◎Housing is made from heavy-duty, impact resistant polyethylene.One shot Roto-molded process brings the housing more strength and long-life usage, no rust forever
- ◎large air volume,less noise give more comfort to animals, 6.2m/s from 6m
- ◎With VFD,can be contoller by APP, PC automatically as the temp and humidity
- ◎With baffle plate to change the direction of the air
- ◎Voltage or housing color can be customized
- ◎APP control, need to purchase gateway(DZJ902) and temperature sensor(DGY601485)

Part No#	Blade Dia cm	RPM	Air Flow m³/h	Power w	Phase	Drive Mode	Voltage	Frequency
YBA072DE CGSB5	183	345	120193	2000	3	direct	380-480	50/60HZ

## 38" FLOOR FAN WHEEL STAND



**APP**

**Control**

- ◎EC MOTOR, brings good heat emission,high efficiency(direct drive),big torque,long-life usage
- ◎Balanced4 stainless steel blades
- ◎Housing is made from high strenth metal
- ◎large air volume exhaust
- ◎With VFD,can be contoller by APP, PC automatically as the temp and humidity
- ◎With steel meshes to protect animals and labors, extra cone can be customized if needed
- ◎Voltage or housing color can be customized
- ◎APP control, need to purchase gateway(DZJ902) and temperature sensor(DGY601485)

Part No#	Blade Dia cm	RPM	Air Flow m³/h	Power w	Phase	Drive Mode	Voltage	Frequency
YBA038BSL DAO	96	750	27000	410	3	direct	380-480	50/60HZ

# Livestock Fans-Exhaust Fans

## 98"EXHAUST FAN ROLL UP DOOR

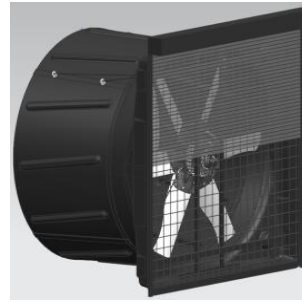

**APP**

**Control**

- ◎EC MOTOR, brings good heat emission,high efficiency(direct drive),big torque,long-life usage
- ◎Balanced 6 Aluminum blades
- ◎Housing is made from high strenth fiberglass.corrosion resistance,easy to clean
- ◎large air volume exhaust,Cone can be extra purchased
- ◎With VFD,can be contoller by APP, PC automatically as the temp and humidity
- ◎With steel meshes to protect animals and labors, extra cone can be customized if needed
- ◎Voltage or housing color can be customized
- ◎APP control, need to purchase gateway(DZJ902) and temperature sensor(DGY601485)

Part No#	Blade Dia cm	RPM	Air Flow m³/h	Power w	Phase	Drive Mode	Voltage	Frequency
YDA098DE CGSKB5	248	310	235000	6000	3	direct	380-480	50/60HZ

## 72" EXHAUST FAN LOUVERED



**APP**

**Control**

- ◎EC MOTOR, brings good heat emission,high efficiency(direct drive),big torque,long-life usage
- ◎Balanced 6 Aluminum blades
- ◎Housing is made from high strenth fiberglass.corrosion resistance,easy to clean
- ◎large air volume exhaust,Cone can be extra purchased
- ◎With VFD,can be contoller by APP, PC automatically as the temp and humidity
- ◎With steel meshes to protect animals and labors, extra cone can be customized if needed
- ◎Voltage or housing color can be customized
- ◎APP control, need to purchase gateway(DZJ902) and temperature sensor(DGY601485)

Part No#	Blade Dia cm	RPM	Air Flow m³/h	Power w	Phase	Drive Mode	Voltage	Frequency
YDA072DE CGSKB5	183	345	120000	2000	3	direct	380-480	50/60HZ

# Livestock Fans-Exhaust Fans

## 48" EXHAUST FAN LOUVERED



**APP**

**Control**

- ◎Balanced 6 fiberglass blades
- ◎Housing is made from high strength fiberglass.corrosion resistance,easy to clean
- ◎6 process testings(noise,shaking,blade speed,air volume,concentricity and efficiency)bring good heat emission,high efficiency(direct drive),big torque,long-life usage
- ◎large air volume,less noise gives more comfort to animals
- ◎Steel meshes fixed on the front and back of the fan protect animals and labours from bruise
- ◎High quality shuttler for easy opening and closing
- ◎Voltage and frequency can be customized

Part No#	Blade Dia cm	RPM	Air Flow m³/h	Power w	Phase	Drive Mode	Voltage	Frequency
YDA048DE CKA0	122	460	45000	850	3	direct	380-480	50/60HZ

## 55" EXHAUST FAN LOUVERED



**APP**

**Control**

- ◎Balanced 6 fiberglass blades
- ◎Housing is made from high strength fiberglass.corrosion resistance,easy to clean
- ◎6 process testings(noise,shaking,blade speed,air volume,concentricity and efficiency)bring good heat emission,high efficiency(direct drive),big torque,long-life usage
- ◎large air volume,less noise gives more comfort to animals
- ◎Steel meshes fixed on the front and back of the fan protect animals and labours from bruise
- ◎High quality shuttler for easy opening and closing
- ◎Voltage and frequency can be customized

Part No#	Blade Dia cm	RPM	Air Flow m³/h	Power w	Phase	Drive Mode	Voltage	Frequency
YDA055DE CKA0	140	460	66000	1200	3	direct	380-480	50/60HZ

# Industrial Fans-Ceiling Fans

## **CEILING FAN EC MOTOR 24FT, 20FT, 18FT , 16FT**

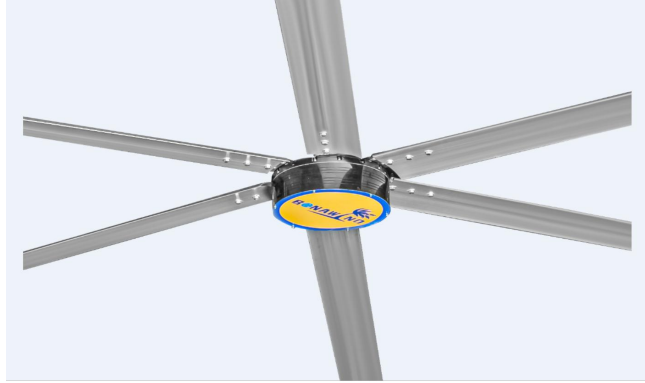

- ◎EC motor, brings good heat emission,high efficiency(direct drive),big torque,long-life usage
- ◎High strength with ribs to reinforce the Aluminum blade
- ◎Maximal air performance, high efficiency
- ◎Easy to maintain and install
- ◎large air volume,less noise(36dba) gives more comfort to animal
- ◎Voltage and frequency can be customized
- ◎With controller,can be contoller by APP, PC automatically as the temp and humidity
- ◎APP control, need to purchase gateway(DZJ902) and temperature sensor(DGY601485)

Part No#	Name	Power(W/hp)	Air Flow (m³/min)	Drive Mode	Blade Size mm/feet
YBA073AL06EC	24FT ceiling fan with 6 blades	1500/2	15000	direct	7300/24FT
YBA060AL06EC	20FT ceiling fan with 6 blades	1200/1.6	14000	direct	6100/20FT
YBA055AL05EC	18FT ceiling fan with 5 blades	1000/1.4	12500	direct	5500/18FT
YBA048AL05EC	16FT ceiling fan with 5 blades	1000/1.4	11500	direct	4900/16FT